

## WALL WASHER TURN AROUND

design  
**Carlotta de Bevilacqua**

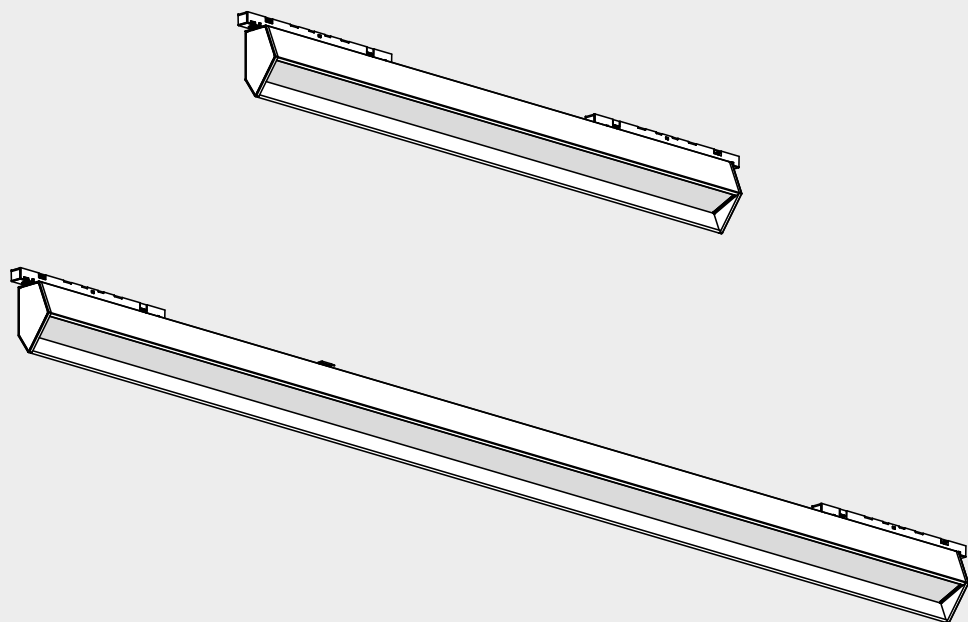



i

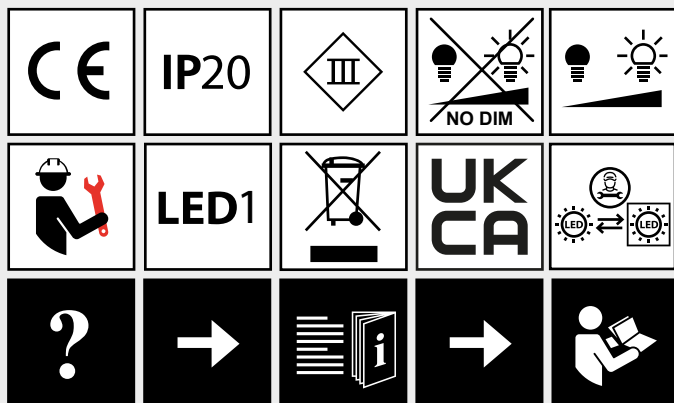

i

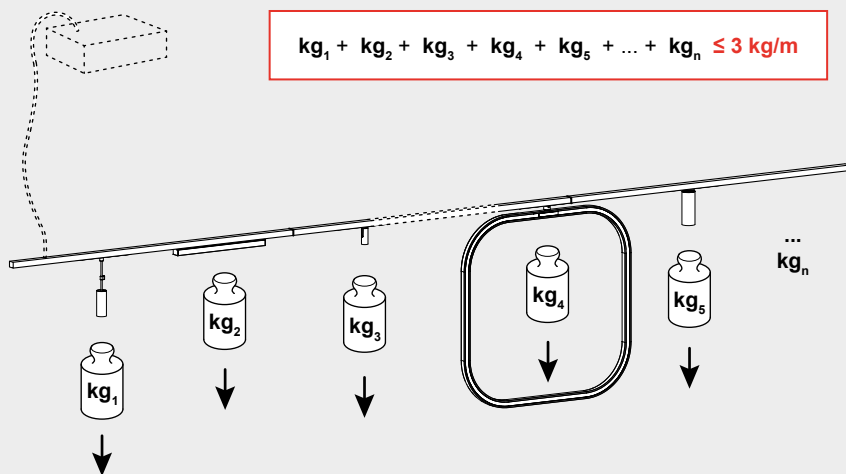



**IT ATTENZIONE**

Per ridurre il rischio di incendio utilizzare solo con il sistema di binari Turn Around

**EN CAUTION**

To reduce the risk of fire use only with Turn Around track system

**FR ATTENTION**

Pour réduire le risque d'incendie, utilisez uniquement le système de chenilles Turn Around.

**ES ADVERTENCIA**

Para reducir el riesgo de incendio, utilícelo sólo con el sistema de carriles Turn Around.

**DEU WARNUNG**

Um die Brandgefahr zu verringern, verwenden Sie das Gerät nur mit dem Turn Around-Schienensystem.

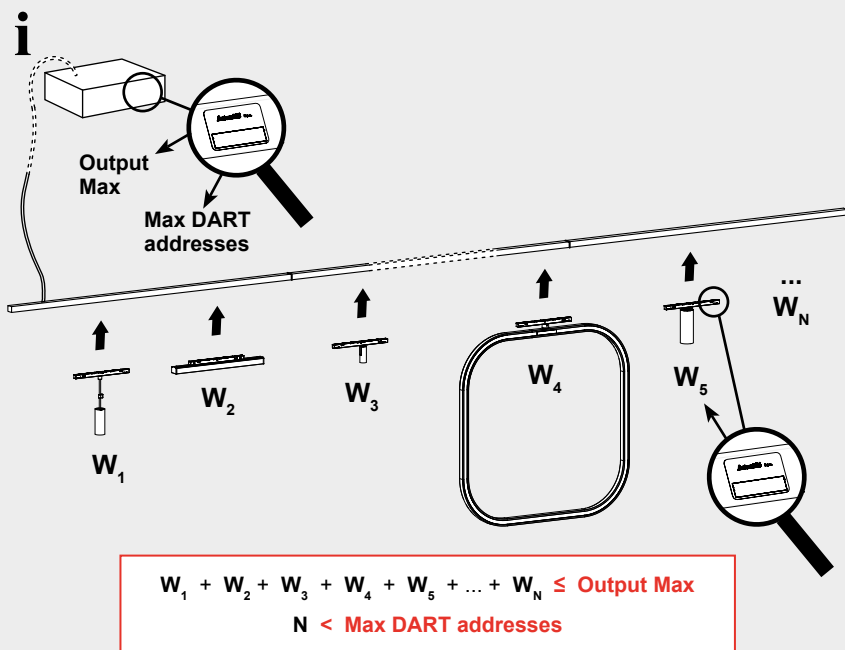

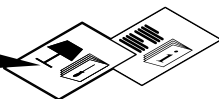

L = 600 mm

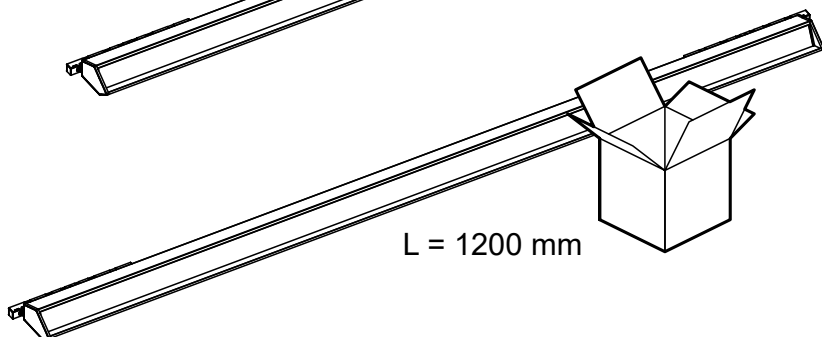
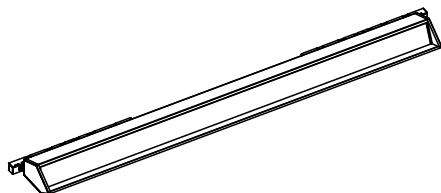
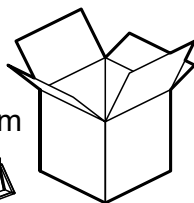

L = 1200 mm

1

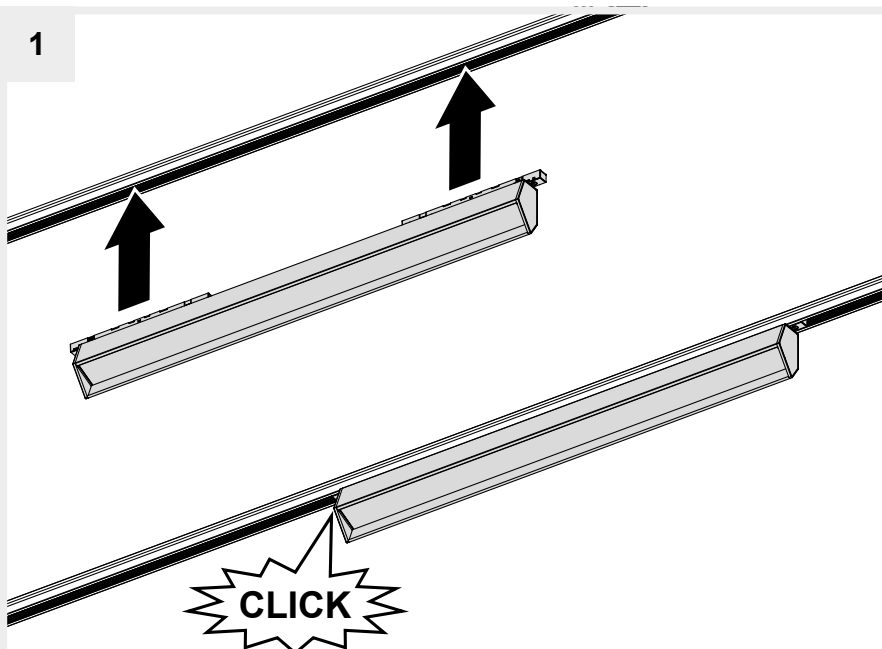

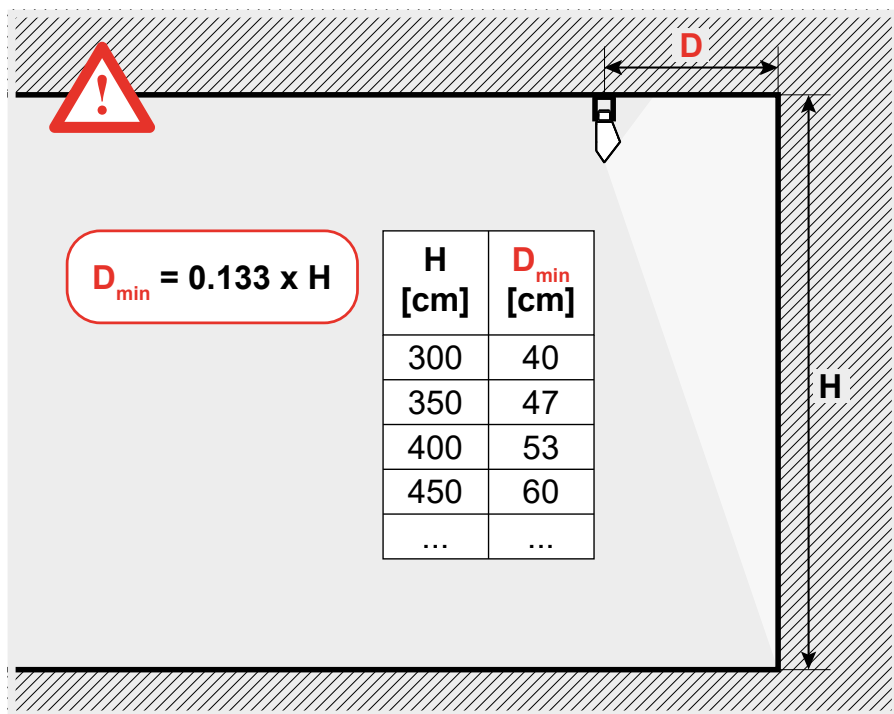

1

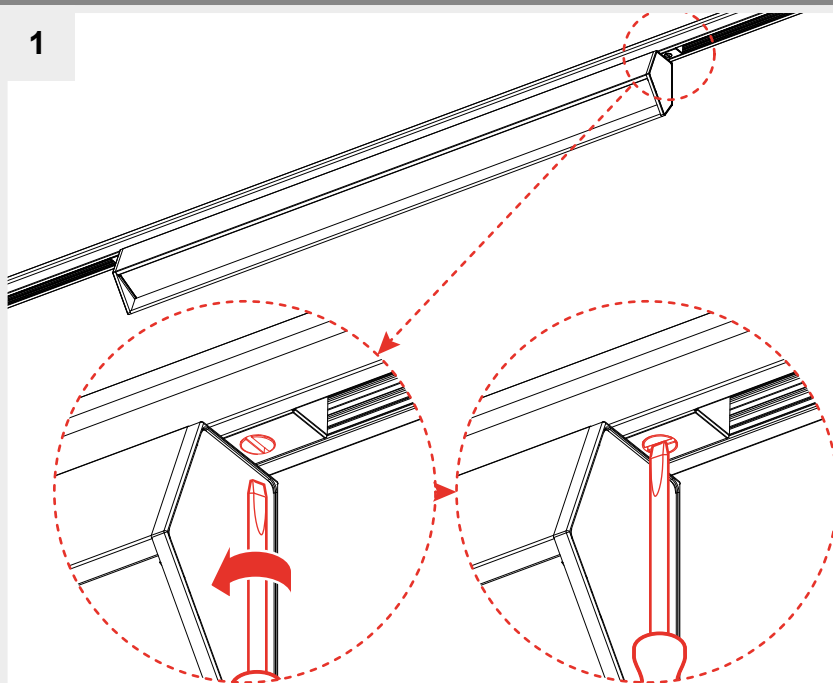

2

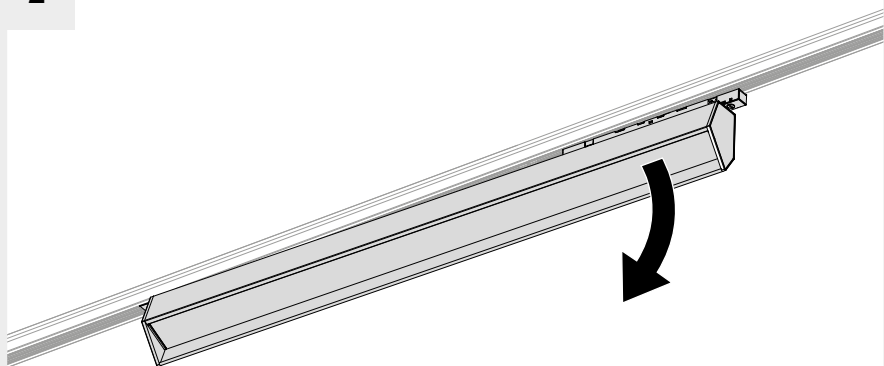

3

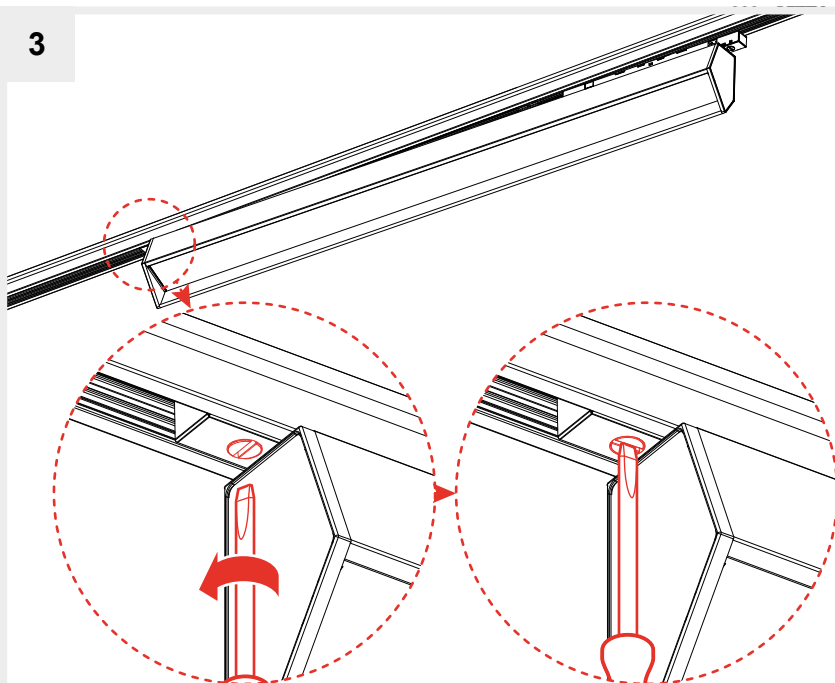

4

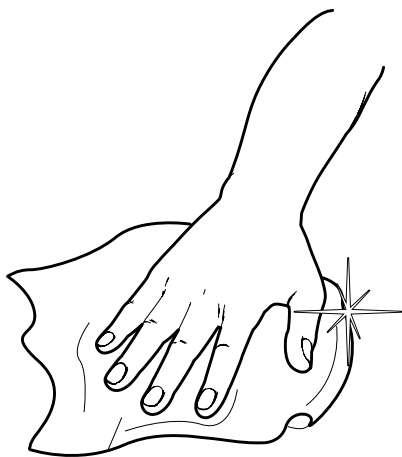
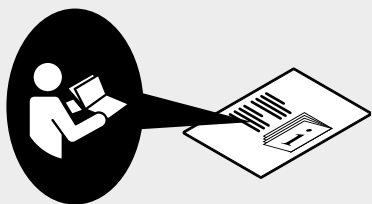
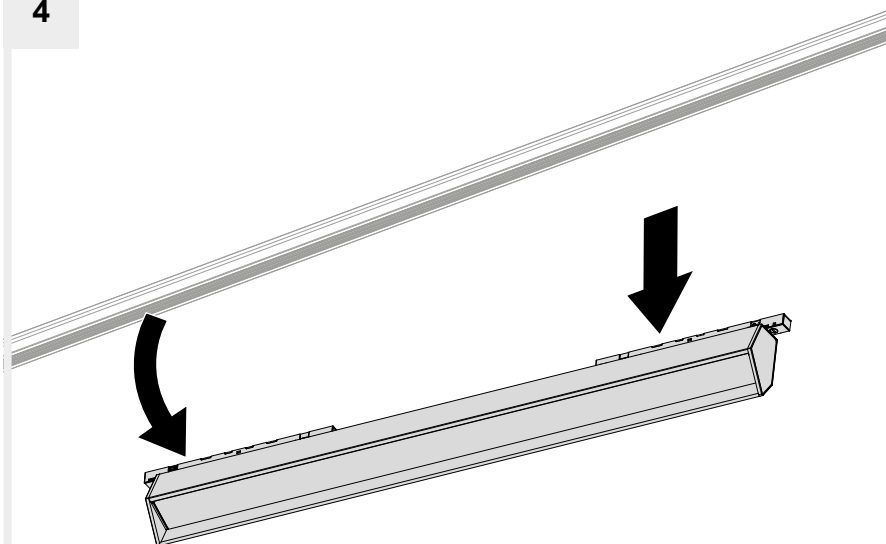

**Artemide®**



**Artemide**

via Bergamo, 18  
20006 Pregnana M.se (MI)  
ITALIA

tel. +39 02 935 181  
fax +39 02 935 90 254  
fax +39 02 935 90 496

[www.artemide.com](http://www.artemide.com)

VAT IT00846890150

**Artemide Inc.**

250 Karin Lane  
Hicksville, NY 11801

tel. 631 694 9292  
Toll Free 1-877-Art-9111  
Fax 631 694 9275

[www.artemide.net](http://www.artemide.net)

cod. Y513002212